

# Premium Booth 3mW x 3mD One side open

SD-A-9  
3mW x 3mD x 3.5mH

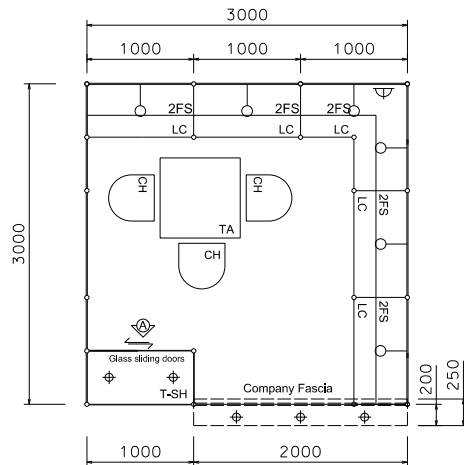

PLAN

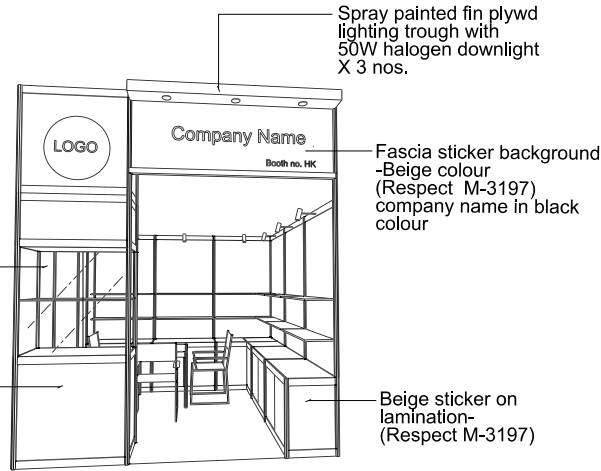

PERSPECTIVE N.T.S.



COLOUR PERSPECTIVE N.T.S.

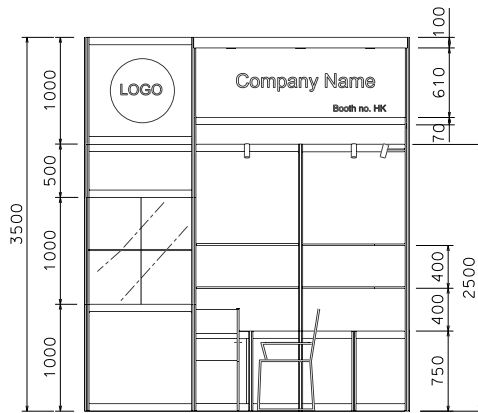

FRONT ELEVATION

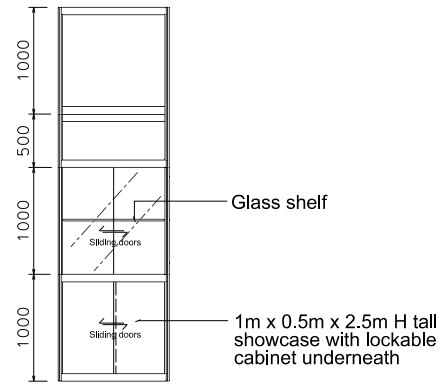

VIEW A

BOOTH SPECIFICATION		QTY
	Tall showcase in beige sticker lamination, 1 layer of glass shelf, 2x 50W halogen downlights	1
	Lockable cabinet in beige sticker lamination (1mL x 0.5mD x 0.75mH)	5.5
	Wooden shelf (flat) (1mL x 0.3mD)	12
	Square meeting table (0.7m X 0.7m x 0.75mH)	1
	Black leather chair	3
	Longarmed spotlight w/23 watt energy saving lamp (yellow)	6
	50W Halogen light (for fascia)	3
	500w Square pin power socket	1
	Company Logo	1

\*The Hong Kong Trade Development Council reserves the right to change the configuration if necessary.

\*如有需要，香港貿易發展局有權更改展台結構。

# Premium Booth 3mW x 3mD Left side Corner Booth

SD-A-9-L\_Cnr  
3mW x 3mD x 3.5mH

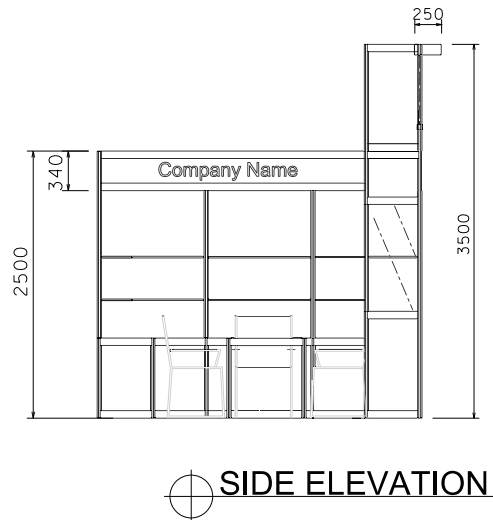
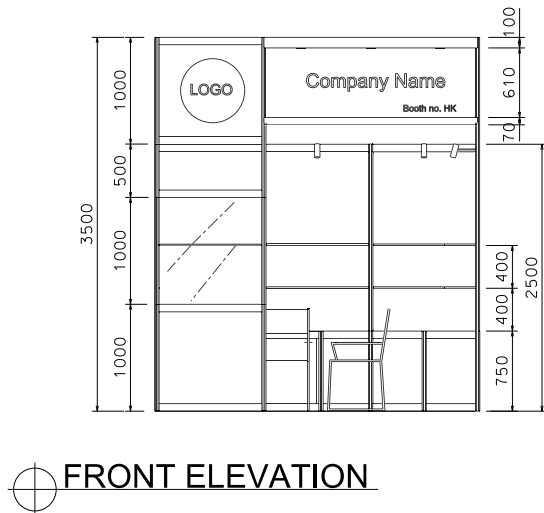
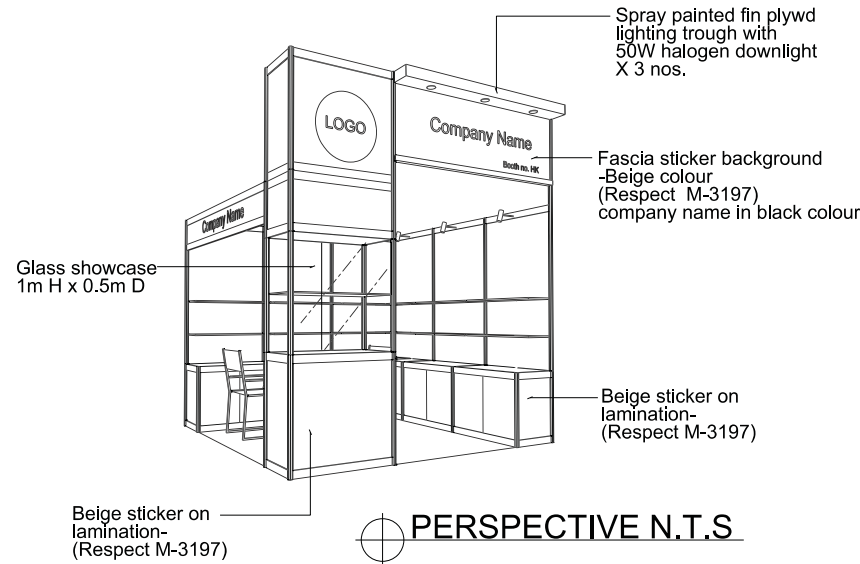
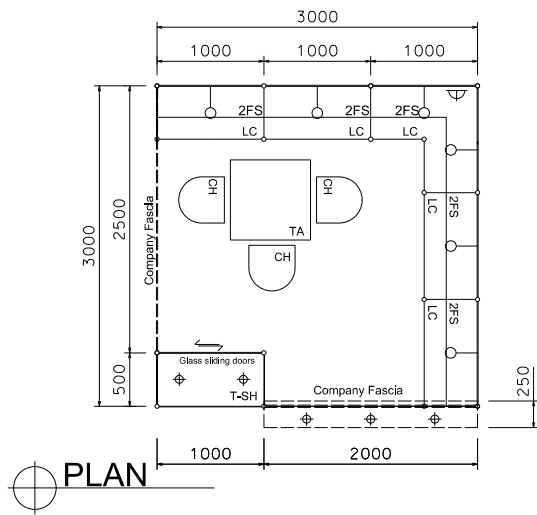

BOOTH SPECIFICATION		QTY
	Tall showcase in beige sticker lamination, 1 layer of glass shelf, 2x 50W halogen downlights	1
	Lockable cabinet in beige sticker lamination (1mL x 0.5mD x 0.75mH)	5.5
	Wooden shelf (flat) (1mL x 0.3mD)	12
	Square meeting table (0.7m X 0.7m x 0.75mH)	1
	Black leather chair	3
	Longarmed spotlight w/23 watt energy saving lamp (yellow)	6
	50W Halogen light (for fascia)	3
	500w Square pin power socket	1
	Company Logo	1

\*The Hong Kong Trade Development Council reserves the right to change the configuration if necessary.

\*如有需要，香港貿易發展局有權更改展台結構。

# Premium Booth 3mW x 3mD Right side Corner Booth

SD-A-9-R\_Cnr  
3mW x 3mD x 3.5mH

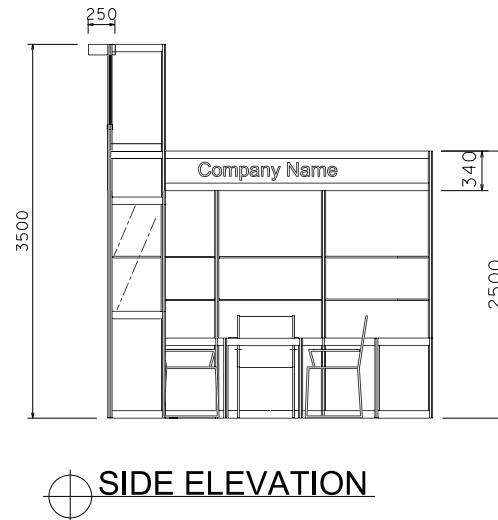
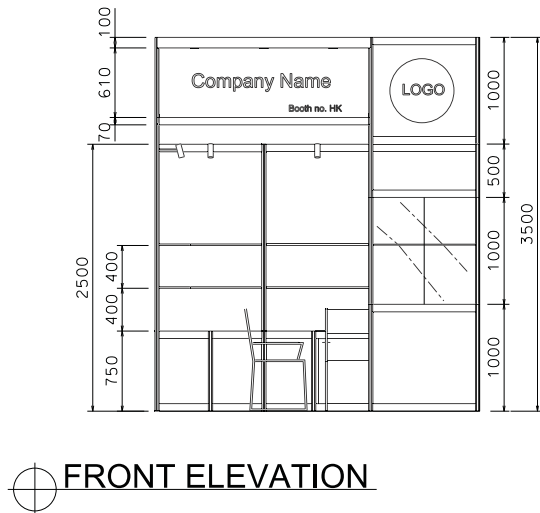
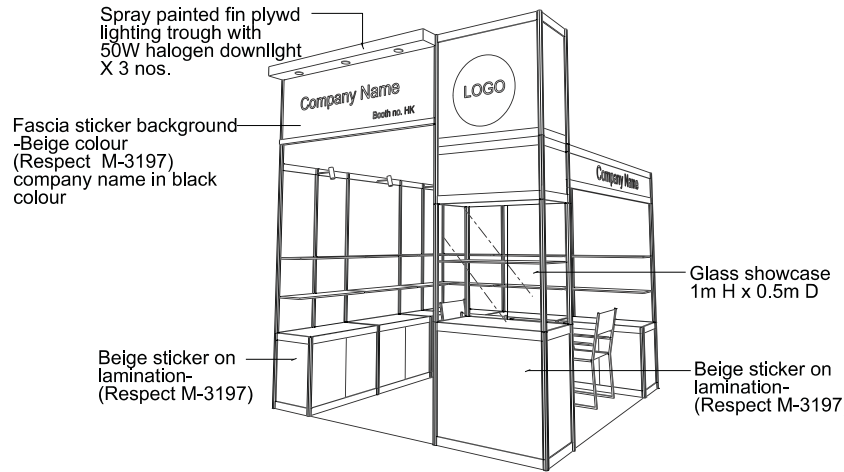
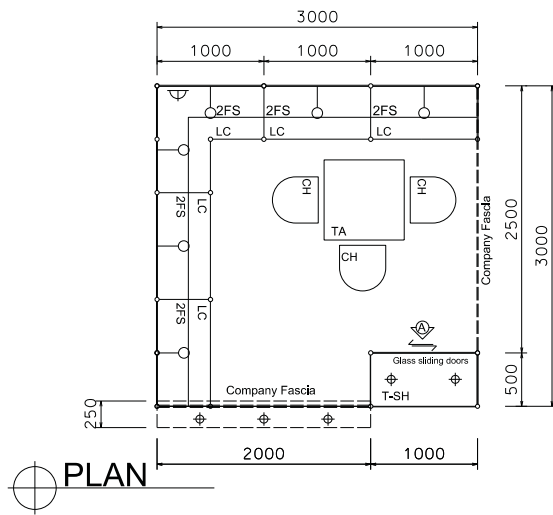

BOOTH SPECIFICATION		QTY
	Tall showcase in beige sticker lamination, 1 layer of glass shelf, 2x 50W halogen downlights	1
	Lockable cabinet in beige sticker lamination (1mL x 0.5mD x 0.75mH)	5.5
	Wooden shelf (flat) (1mL x 0.3mD)	12
	Square meeting table (0.7m X 0.7m x 0.75mH)	1
	Black leather chair	3
	Longarmed spotlight w/23 watt energy saving lamp (yellow)	6
	50W Halogen light (for fascia)	3
	500w Square pin power socket	1
	Company Logo	1

\*The Hong Kong Trade Development Council reserves the right to change the configuration if necessary.

\*如有需要，香港貿易發展局有權更改展台結構。

# Premium Booth 3mW x 5mD One side open

SD-A-15  
3mW x 5mD x 3.5mH

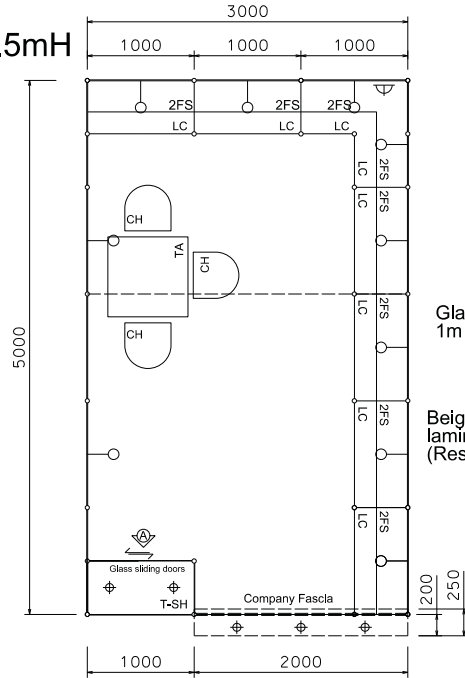

PLAN

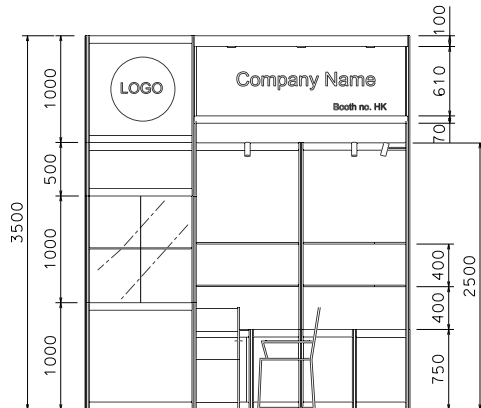

FRONT ELEVATION

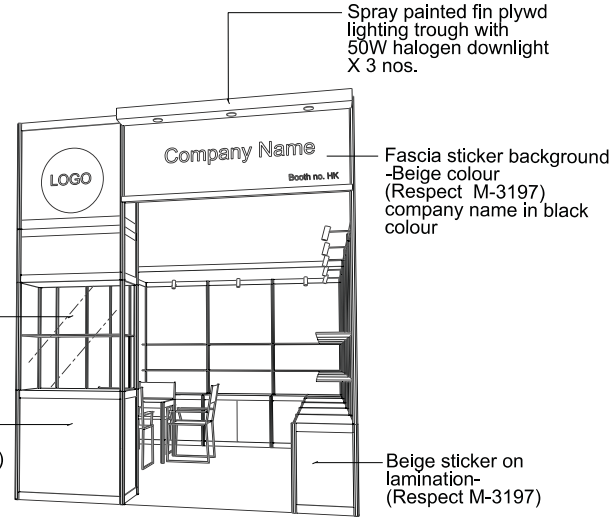

PERSPECTIVE N.T.S.



COLOUR PERSPECTIVE N.T.S.

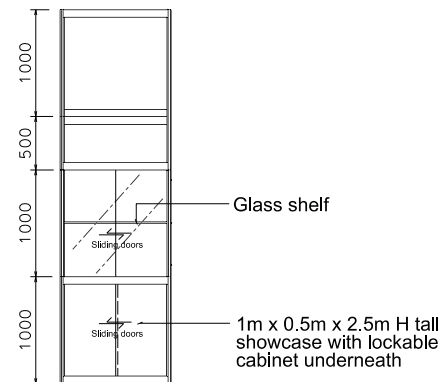

VIEW A

BOOTH SPECIFICATION		QTY
	Tall showcase in beige sticker lamination, 1 layer of glass shelf, 2x 50W halogen downlights	1
	Lockable cabinet in beige sticker lamination (1mL x 0.5mD x 0.75mH)	7.5
	Wooden shelf (flat) (1mL x 0.3mD)	16
	Square meeting table (0.7m X0.7m x 0.75mH)	1
	Black leather chair	3
	Longarmed spotlight w/23 watt energy saving lamp (yellow)	10
	50W Halogen light (for fascia)	3
	500w Square pin power socket	1
	Company Logo	1

FILE PATH - L:\Local Fair Premium Booth 2011\SD-Layouts\SD-A layout\SD-A-Layout-New.dgn

\*The Hong Kong Trade Development Council reserves the right to change the configuration if necessary.

\*如有需要，香港貿易發展局有權更改展台結構。

# Premium Booth 3mW x 5mD Left side Corner Booth

SD-A-15-L\_Cnr  
3mW x 5mD x 3.5mH

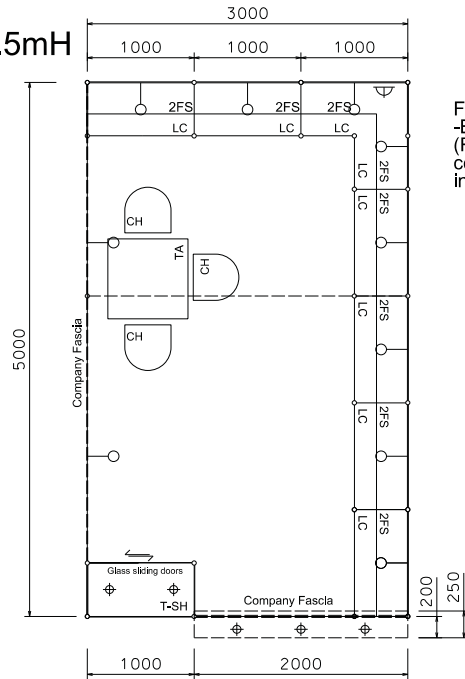

PLAN

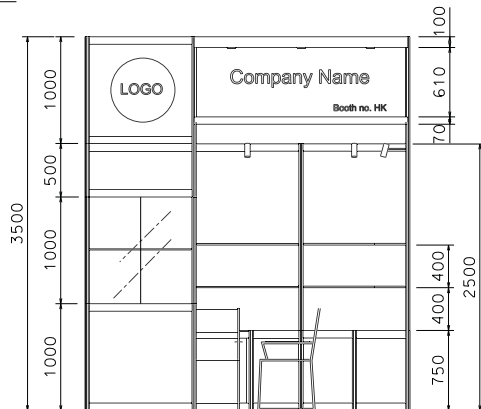

FRONT ELEVATION

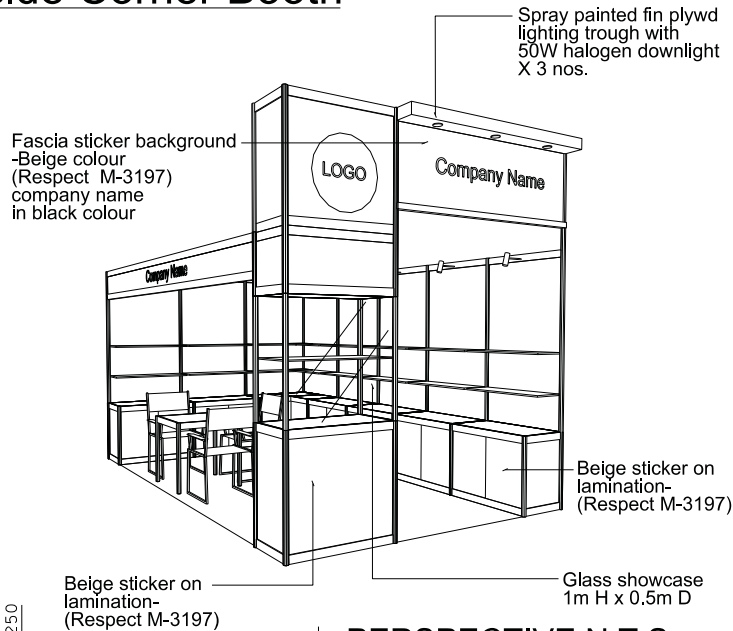

PERSPECTIVE N.T.S



COLOUR PERSPECTIVE N.T.S

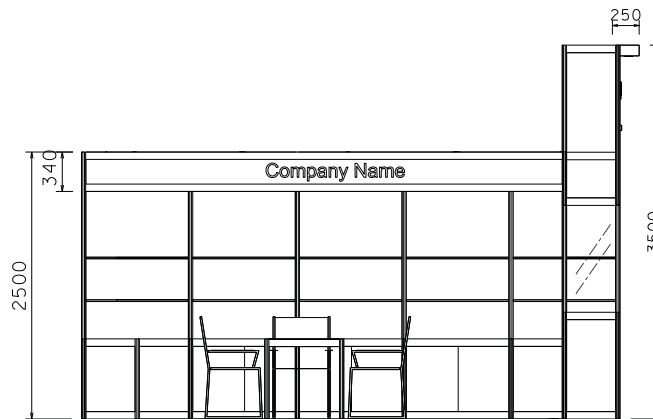

SIDE ELEVATION

BOOTH SPECIFICATION		QTY
	Tall showcase in beige sticker lamination, 1 layer of glass shelf, 2x 50W halogen downlights	1
	Lockable cabinet in beige sticker lamination (1mL x 0.5mD x 0.75mH)	7.5
	Wooden shelf (flat) (1mL x 0.3mD)	16
	Square meeting table (0.7m X0.7m x 0.75mH)	1
	Black leather chair	3
	Longarmed spotlight w/23 watt energy saving lamp (yellow)	10
	50W Halogen light (for fascia)	3
	500w Square pin power socket	1
	Company Logo	1

\*The Hong Kong Trade Development Council reserves the right to change the configuration if necessary.

\*如有需要，香港貿易發展局有權更改展台結構。

# Premium Booth 3mW x 5mD Right side Corner Booth

SD-A-15-R Cnr  
3mW x 5mD x 3.5mH

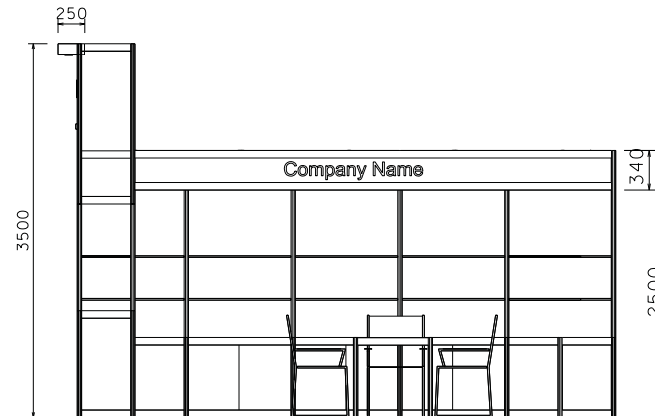
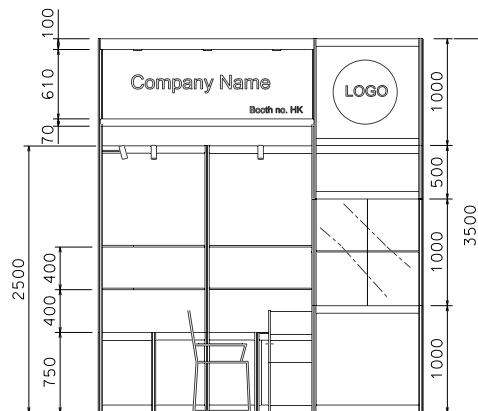
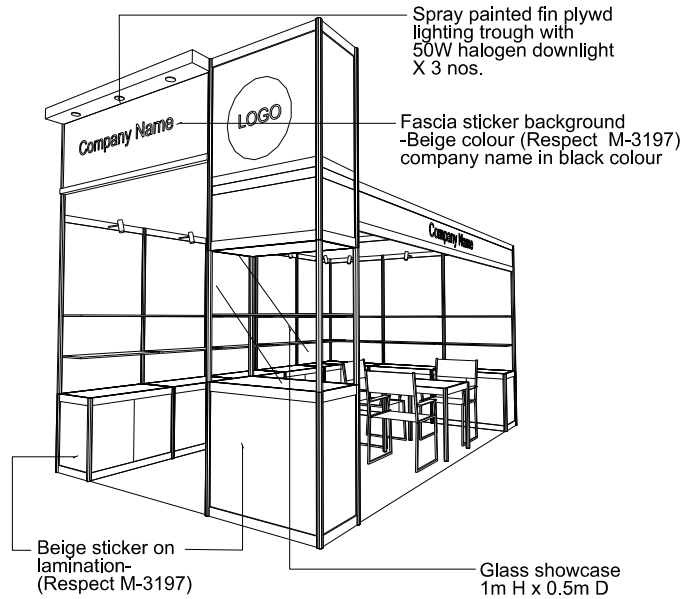
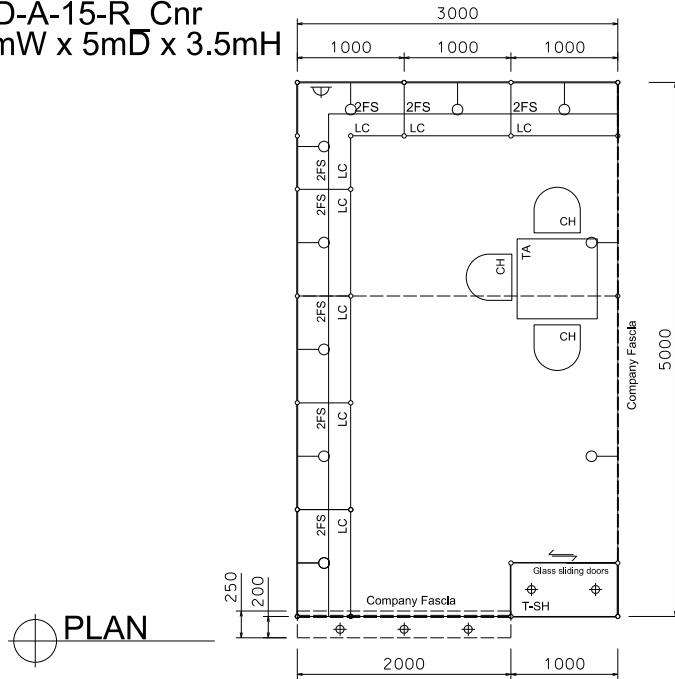

BOOTH SPECIFICATION		QTY
	Tall showcase in beige sticker lamination, 1 layer of glass shelf, 2x 50W halogen downlights	1
	Lockable cabinet in beige sticker lamination (1mL x 0.5mD x 0.75mH)	7.5
	Wooden shelf (flat) (1mL x 0.3mD)	16
	Square meeting table (0.7m X 0.7m x 0.75mH)	1
	Black leather chair	3
	Longarmed spotlight w/23 watt energy saving lamp (yellow)	10
	50W Halogen light (for fascia)	3
	500w Square pin power socket	1
	Company Logo	1

\*The Hong Kong Trade Development Council reserves the right to change the configuration if necessary.

\*如有需要，香港貿易發展局有權更改展台結構。

# Premium Booth 6mW x 3mD One side open

SD-A-18  
6mW x 3mD x 3.5mH

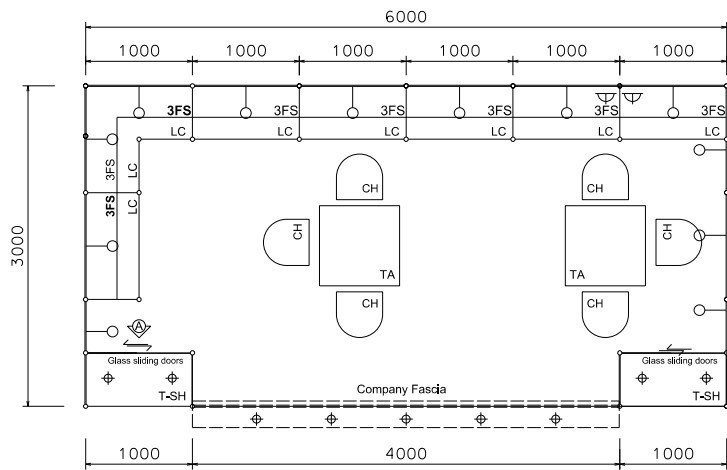

PLAN

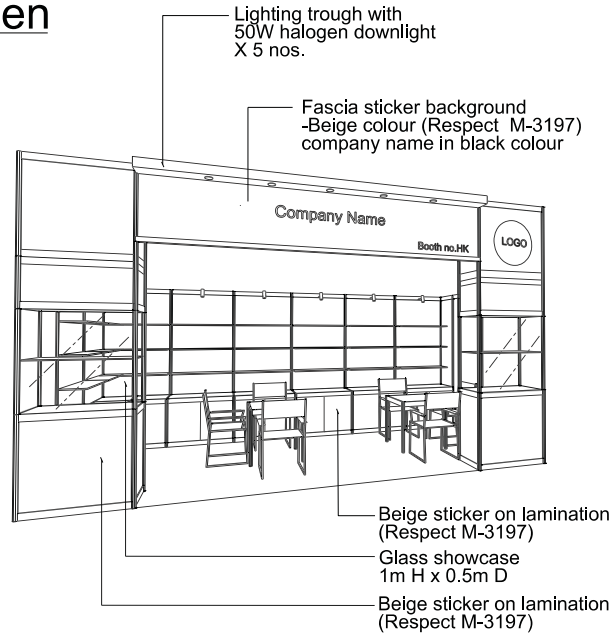

PERSPECTIVE N.T.S



COLOUR PERSPECTIVE N.T.S

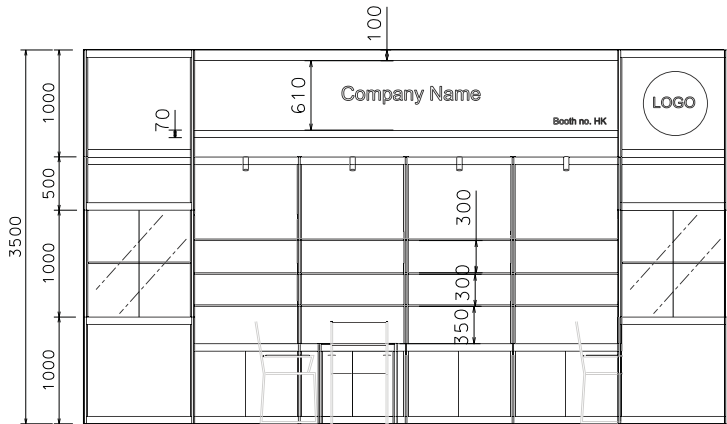

FRONT ELEVATION

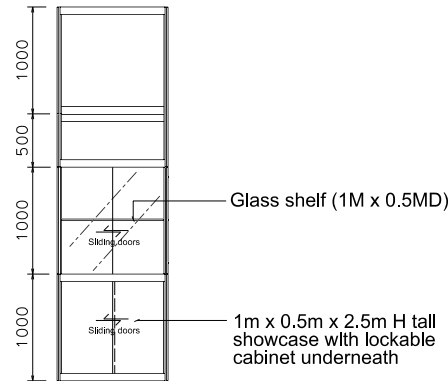

VIEW A

BOOTH SPECIFICATION		QTY
	Tall showcase in beige sticker lamination, 1 layer of glass shelf, 2x 50W halogen downlights	2
	Lockable cabinet in beige sticker lamination (1mL x 0.5mD x 0.75mH)	7.5
	Wooden shelf (flat) (1mL x 0.3mD)	24
	Square meeting table (0.7m X0.7m x 0.75mH)	2
	Black leather chair	6
	Longarmed spotlight w/23 watt energy saving lamp (yellow)	12
	50W Halogen light (for fascia)	5
	500w Square pin power socket	2
	Company Logo	1

FILE PATH - L:\Local Fair Premium Booth 2011\SD\SD-Layouts\SD-A layout\SD-A-Layout-New.dgn

\*The Hong Kong Trade Development Council reserves the right to change the configuration if necessary.

\*如有需要，香港貿易發展局有權更改展台結構。



# Premium Booth 6mW x 3mD Left side Corner Booth

SD-A-18-L\_Cnr  
6mW x 3mD x 3.5mH

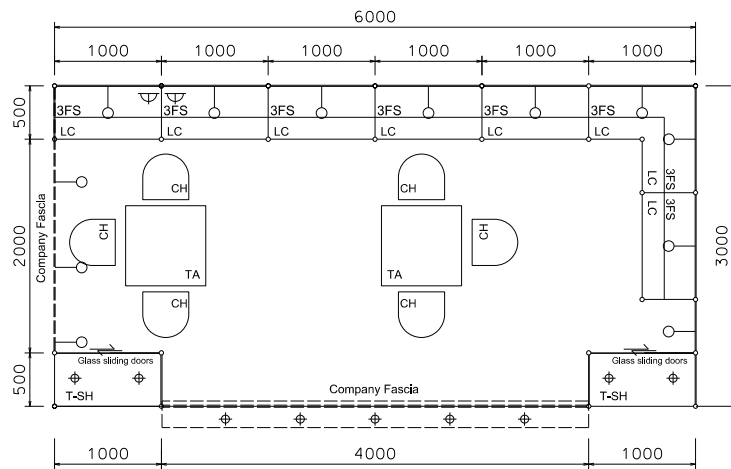

PLAN

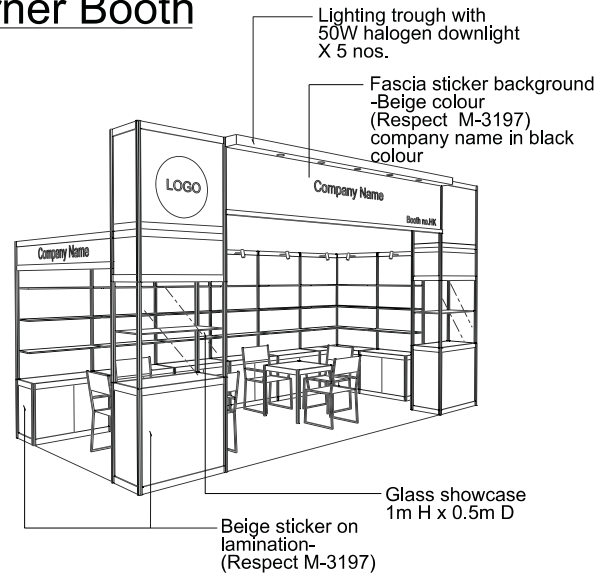

PERSPECTIVE N.T.S.



COLOUR PERSPECTIVE N.T.S.

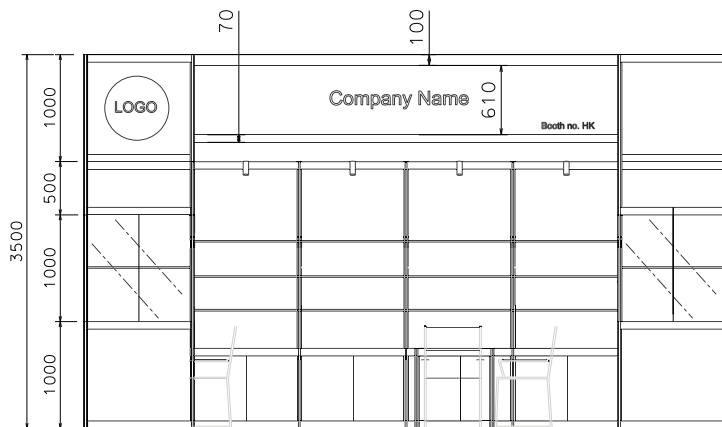

FRONT ELEVATION

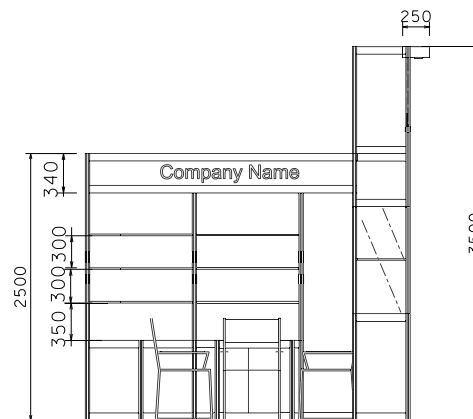

SIDE ELEVATION

BOOTH SPECIFICATION		QTY
	Tall showcase in beige sticker lamination, 1 layer of glass shelf, 2x 50W halogen downlights	2
	Lockable cabinet in beige sticker lamination (1mL x 0.5mD x 0.75mH)	7.5
	Wooden shelf (flat) (1mL x 0.3mD)	24
	Square meeting table (0.7m X0.7m x 0.75mH)	2
	Black leather chair	6
	Longarmed spotlight w/23 watt energy saving lamp (yellow)	12
	50W Halogen light (for fascia)	5
	500w Square pin power socket	2
	Company Logo	1

\*The Hong Kong Trade Development Council reserves the right to change the configuration if necessary.

\*如有需要，香港貿易發展局有權更改展台結構。



# Premium Booth 6mW x 3mD Right side open Corner Booth

SD-A-18-R Cnr  
6mW x 3mD x 3.5mH

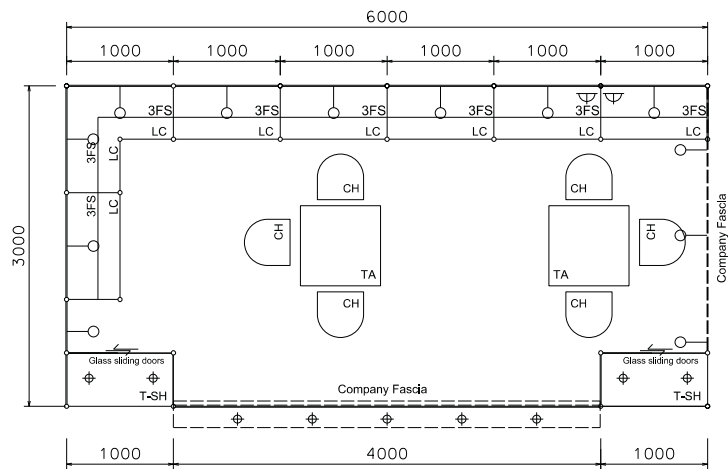

PLAN

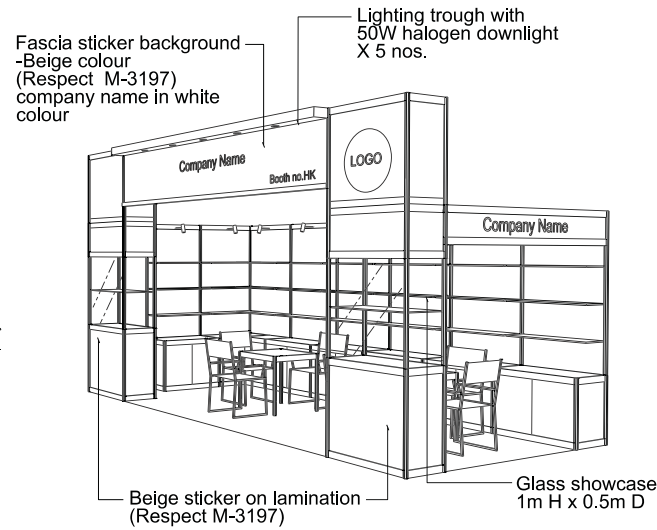

PERSPECTIVE N.T.S.



COLOUR PERSPECTIVE N.T.S.

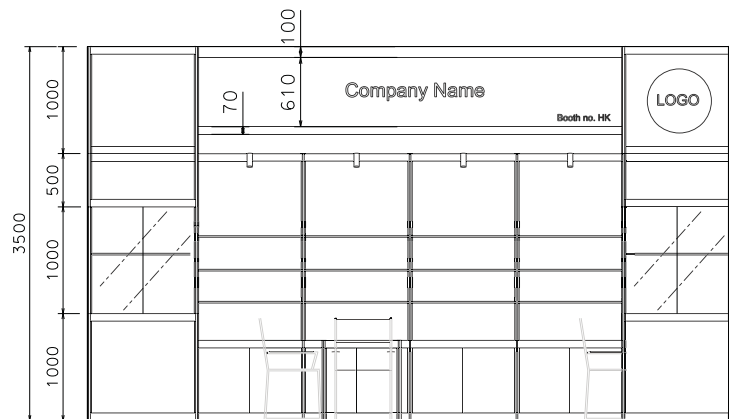

FRONT ELEVATION

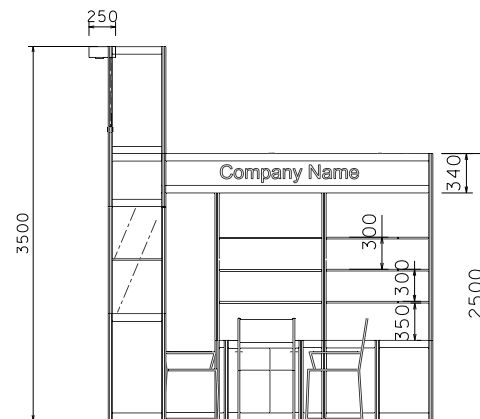

SIDE ELEVATION

BOOTH SPECIFICATION		QTY
	Tall showcase in beige sticker lamination, 1 layer of glass shelf, 2x 50W halogen downlights	2
	Lockable cabinet in beige sticker lamination (1mL x 0.5mD x 0.75mH)	7.5
	Wooden shelf (flat) (1mL x 0.3mD)	24
	Square meeting table (0.7m X0.7m x 0.75mH)	2
	Black leather chair	6
	Longarmed spotlight w/23 watt energy saving lamp (yellow)	12
	50W Halogen light (for fascia)	5
	500w Square pin power socket	2
	Company Logo	1

\*The Hong Kong Trade Development Council reserves the right to change the configuration if necessary.

\*如有需要，香港貿易發展局有權更改展台結構。

# Premium Booth 9mW x 3mD One side open

SD-A-27  
9mW x 3mD x 3.5mH

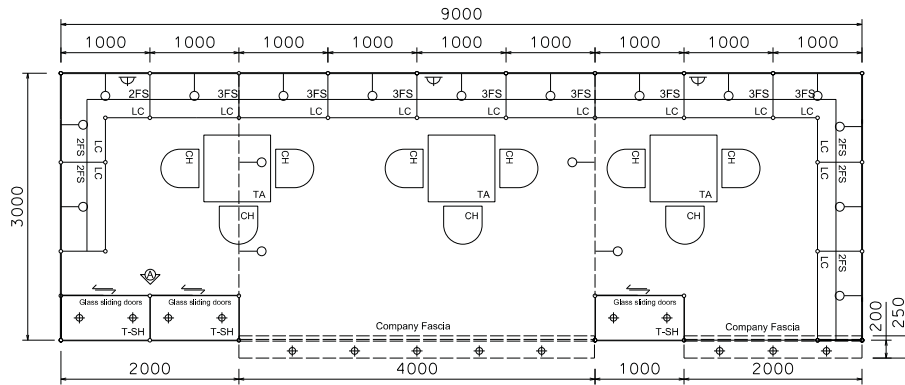

PLAN

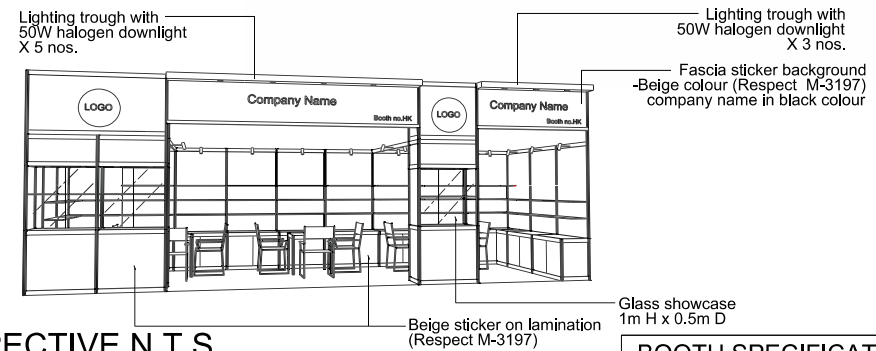

PERSPECTIVE N.T.S

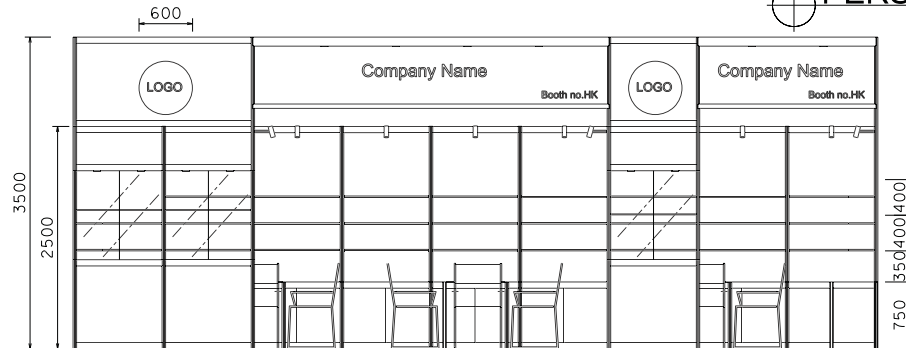

FRONT ELEVATION

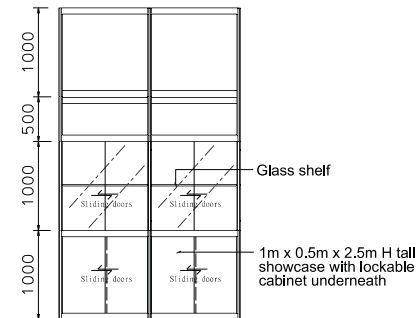

VIEW A

BOOTH SPECIFICATION		QTY
	Tall showcase in beige sticker lamination, 1 layer of glass shelf, 2x 50W halogen downlights	3
	Lockable cabinet in beige sticker lamination (1mL x 0.5mD x 0.75mH)	13
	Wooden shelf (flat) (1mL x 0.3mD)	36
	Square meeting table (0.7m X 0.7m x 0.75mH)	3
	Black leather chair	9
	Longarmed spotlight w/23 watt energy saving lamp (yellow)	18
	50W Halogen light (for fascia)	8
	500w Square pin power socket	3
	Company Logo	2

\*The Hong Kong Trade Development Council reserves the right to change the configuration if necessary.

\*如有需要，香港貿易發展局有權更改展台結構。

# Premium Booth 9mW x 3mD Left Corner Booth

SD-A-27\_L-Cnr  
9mW x 3mD x 3.5mH

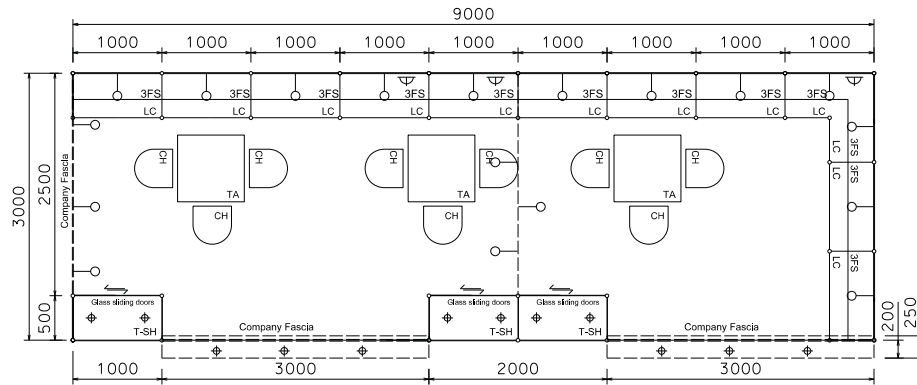

PLAN

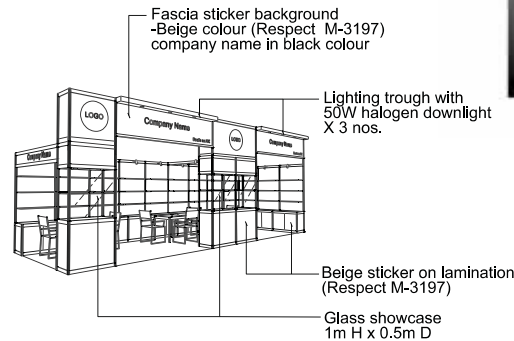

PERSPECTIVE N.T.S

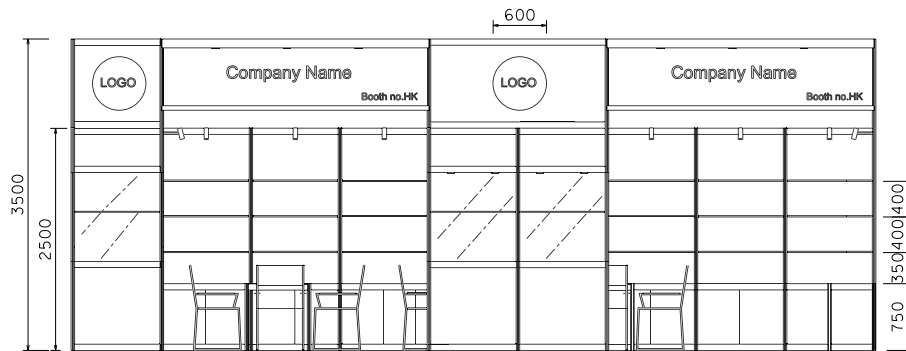

FRONT ELEVATION

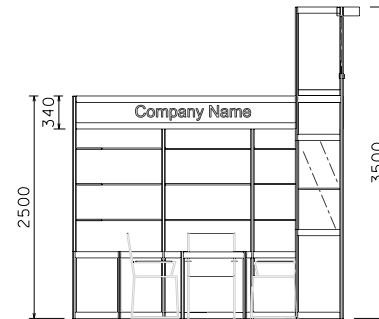

SIDE ELEVATION

BOOTH SPECIFICATION		QTY
	Tall showcase in beige sticker lamination, 1 layer of glass shelf, 2x 50W halogen downlights	3
	Lockable cabinet in beige sticker lamination (1mL x 0.5mD x 0.75mH)	11.5
	Wooden shelf (flat) (1mL x 0.3mD)	36
	Square meeting table (0.7m X 0.7m x 0.75mH)	3
	Black leather chair	9
	Longarmed spotlight w/23 watt energy saving lamp (yellow)	18
	50W Halogen light (for fascia)	6
	500w Square pin power socket	3
	Company Logo	2

\*The Hong Kong Trade Development Council reserves the right to change the configuration if necessary.

\*如有需要，香港貿易發展局有權更改展台結構。

# Premium Booth 9mW x 3mD Right Corner Booth

SD-A-27\_R-Cnr  
9mW x 3mD x 3.5mH

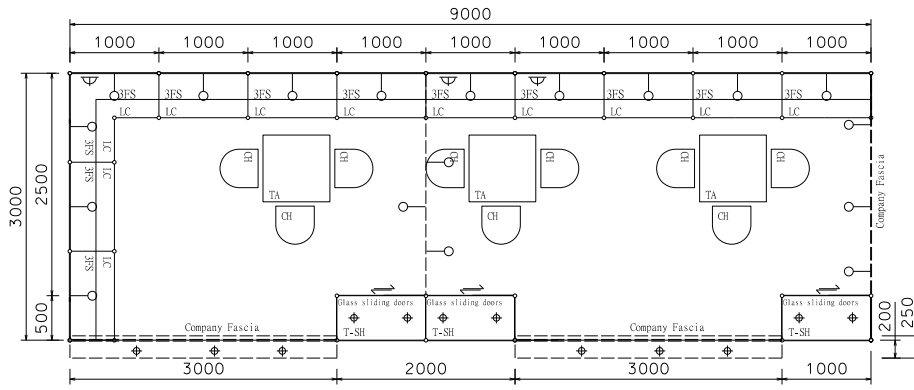

Fascia sticker background  
-Beige colour (Respect M-3197)  
company name in black colour

Lighting trough with  
50W halogen  
downlight  
X 3 nos.

Beige sticker on  
lamination  
(Respect M-3197)

Glass showcase  
1m H x 0.5m D

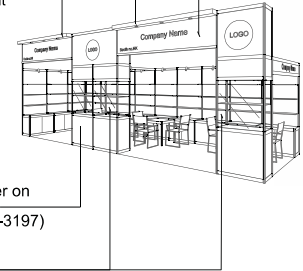

PLAN

PERSPECTIVE N.T.S

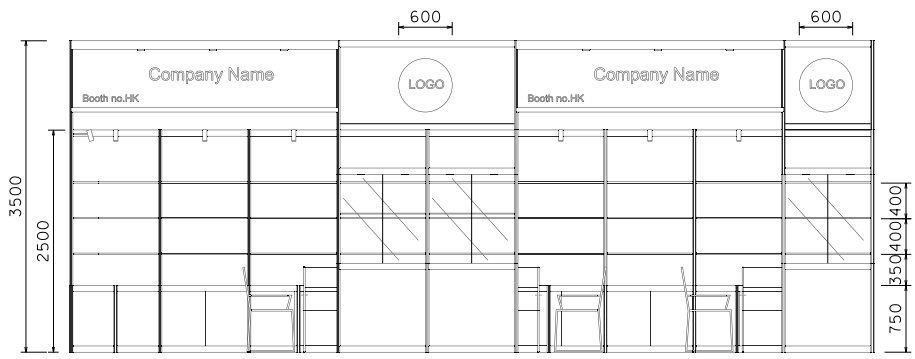

FRONT ELEVATION

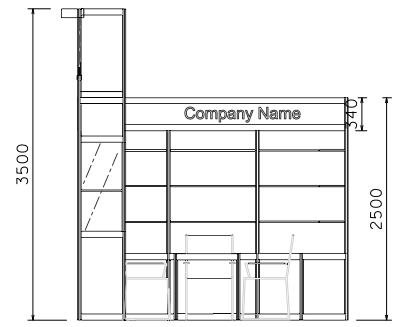

SIDE ELEVATION

BOOTH SPECIFICATION		QTY
	Tall showcase in beige sticker lamination, 1 layer of glass shelf, 2x 50W halogen downlights	3
	Lockable cabinet in beige sticker lamination (1mL x 0.5mD x 0.75mH)	11.5
	Wooden shelf (flat) (1mL x 0.3mD)	36
	Square meeting table (0.7m X 0.7m x 0.75mH)	3
	Black leather chair	9
	Longarmed spotlight w/23 watt energy saving lamp (yellow)	18
	50W Halogen light (for fascia)	6
	500w Square pin power socket	3
	Company Logo	2

FILE PATH: L:\Local Fair\Premium Booth 2011\SD\SD-LAYOUTS\SD-A layout\SD-A-Layout\_New.dgn

\*The Hong Kong Trade Development Council reserves the right to change the configuration if necessary.

\*如有需要，香港貿易發展局有權更改展台結構。