

# Premium Booth 3mW x 3mD One side open

**SD-C-9**  
3mW x 3mD x 3.5mH

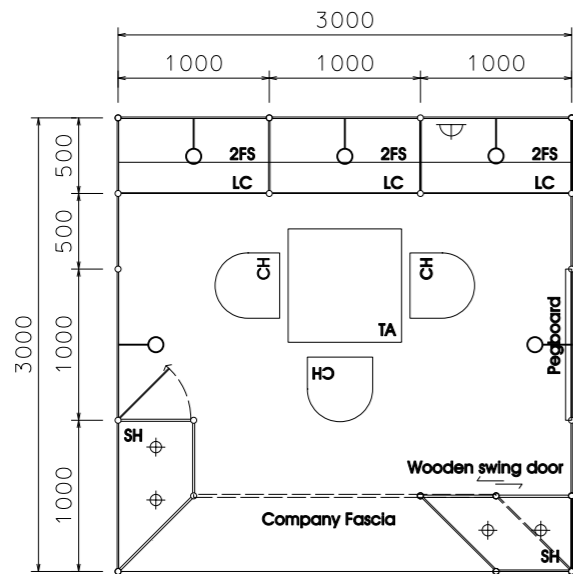

**PLAN**



**PERSPECTIVE N.T.S**

- Company Fascia  
2000mmW x 700mm H  
Panel in colour laminate stickers  
-Pantone #725C (Respect M-3176)  
-Pantone #291C (Respect M-3173)
- Panel in colour sticker lamination  
-pantone #725C (Respect M-3176)
- Glass showcase with white wooden sliding door  
(1000mmW x500mmD x2500mmH) with 2x 50W halogen downlight)
- Glass showcase with white wooden swing door  
(1000mmW x500mmD x2500mmH) with 2x 50W halogen downlight)
- Plywd panel in colour sticker laminations  
-Pantone #725C (Respect M-3176)  
-Pantone #291C (Respect M-3173)



**COLOUR PERSPECTIVE N.T.S**

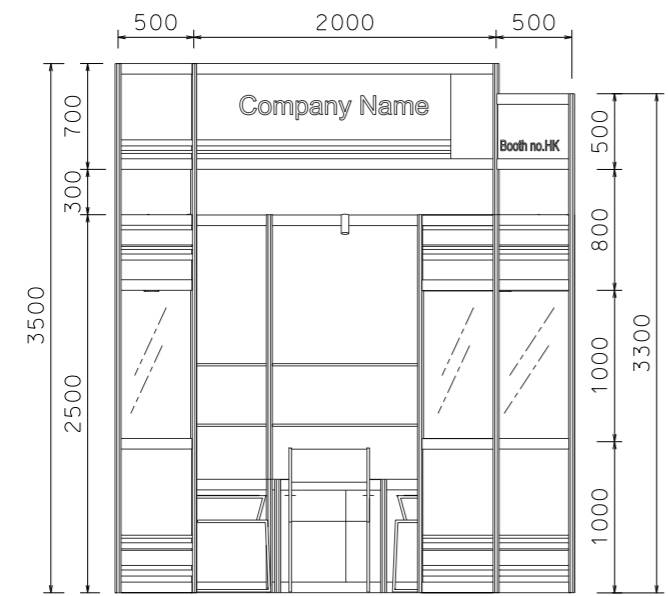

**FRONT ELEVATION**

BOOTH SPECIFICATION	QTY
Front glass showcase in sticker lamination with white wooden swing door. 2 x (50W) halogen downlight (1M W x 0.5mD x 2.5M H)	1
Front glass showcase in sticker lamination with white wooden sliding doors. 2 x (50W) halogen downlight (1M W x 0.5mD x 2.5M H)	1
Lockable cabinet (1mL x 0.5mD x 0.75mH)	3
Wooden shelf (flat) (1mL x 0.3mD)	6
Pegboard with 30 hooks (1mW x 2.5mH)	1
Square meeting table (0.7m X0.7m x 0.75mH)	1
Black leather chair	3
100W Longarm spotlight	5
500w Square pin power socket	1

FILE PATH - K:\Local Fair Premium Booth 2009-2010\Booth Layout\Module-A-(SD)\SD-Layouts\SD-C-layout\SD-C-2d.layout.dgn

	<b>NOTES</b> UNLESS OTHERWISE SPECIFIED ALL DIMENSIONS ARE IN MM.	<b>REVISION</b> 05-01-2009 07-01-2009 16-01-2009 21-01-2009	<b>DATE:</b> 31-12-2008	<b>TITLE</b> Premium Booth SD-C-9	<b>PROJECT</b> PREMIUM BOOTH 3m x 3m DATE: XXXXXXXX	SHEET SD-C01
	.....	.....	<b>SCALE:</b> 1 : 50 (A3)			
.....	.....	.....	<b>CHECKED BY:</b> .....			