

Premium Booth 3mW x 3mD Right side Corner Booth

SD-A-9-R Cnr
3mW x 3mD x 3.5mH

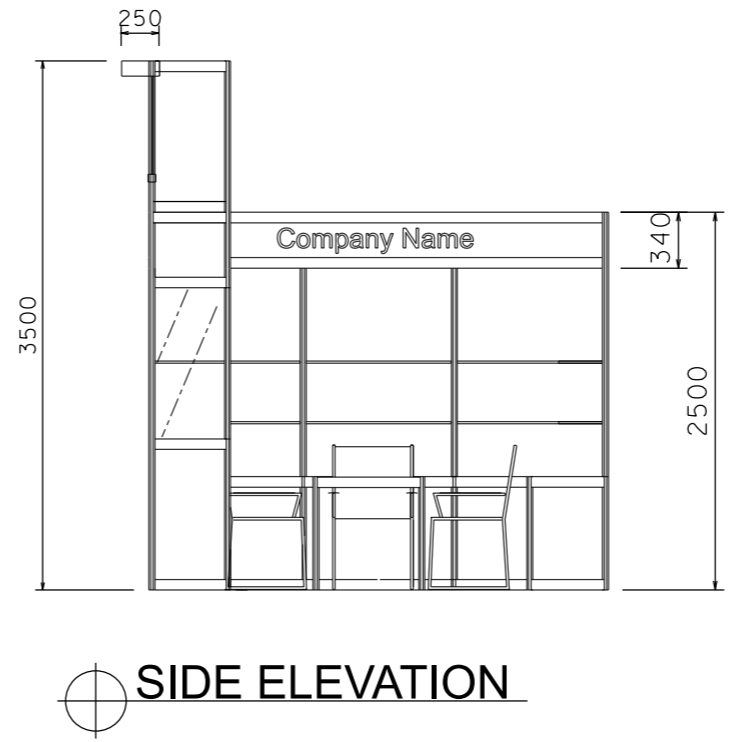
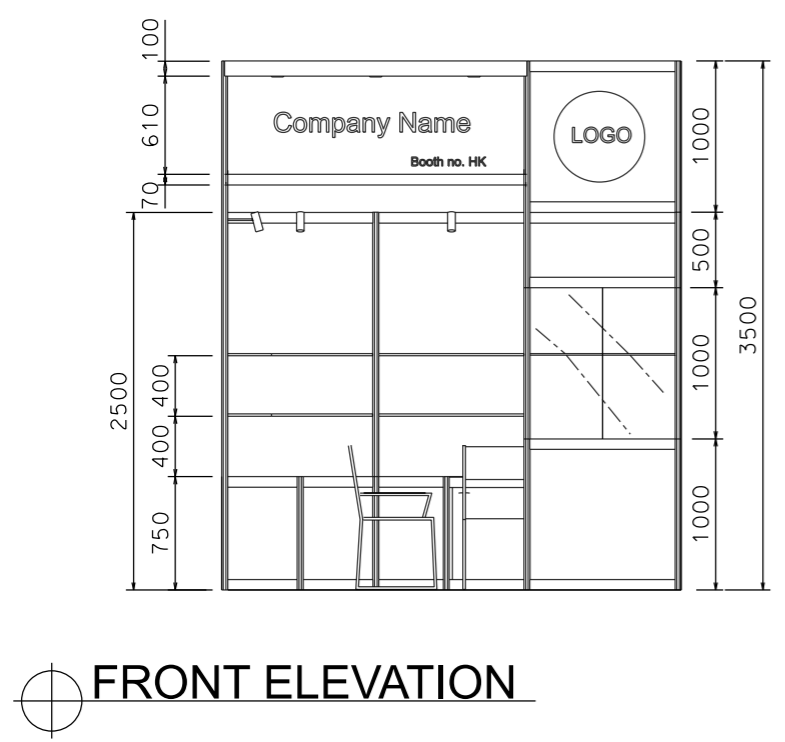
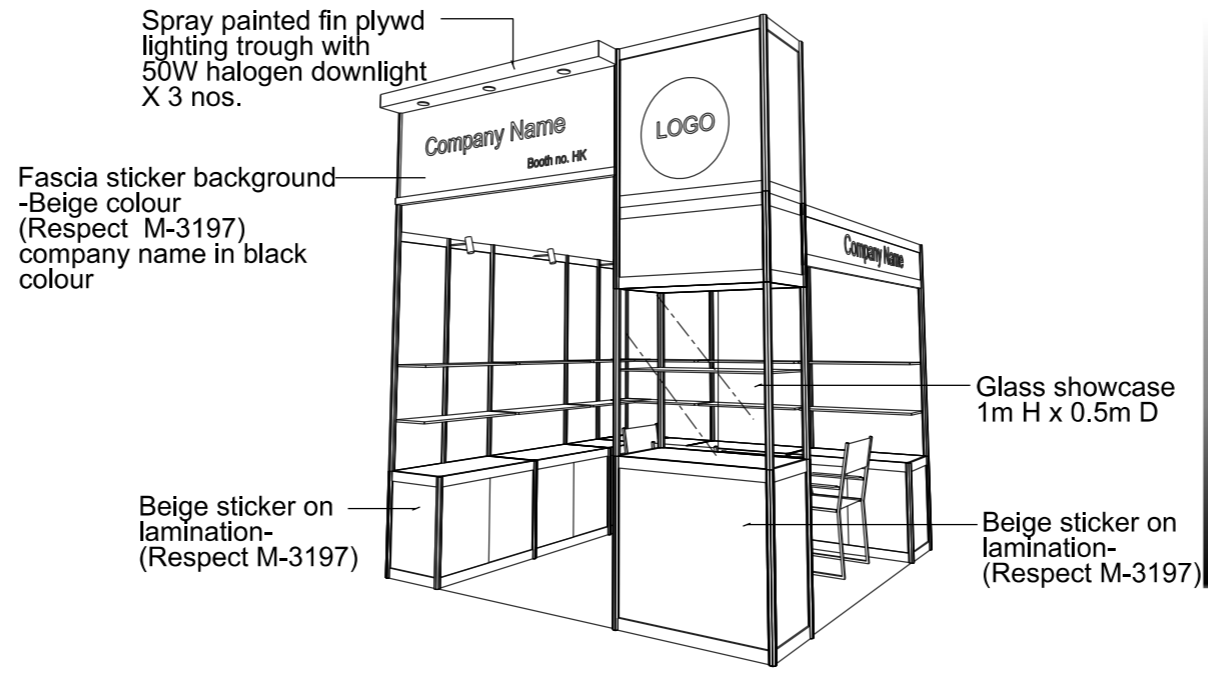
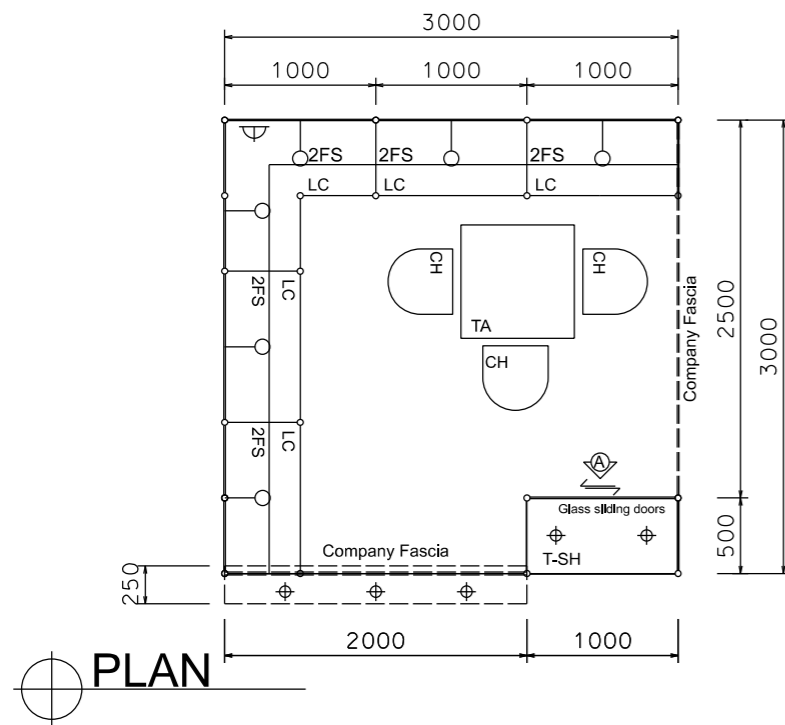

BOOTH SPECIFICATION		QTY
	Tall showcase in beige sticker lamination, 1 layer of glass shelf, 2x 50W halogen downlights	1
	Lockable cabinet in beige sticker lamination (1mL x 0.5mD x 0.75mH)	5.5
	Wooden shelf (flat) (1mL x 0.3mD)	12
	Square meeting table (0.7m X0.7m x 0.75mH)	1
	Black leather chair	3
	13W LED Lamp Longarmed Spotlight (yellow)	6
	50W Halogen light (for fascia)	3
	500w Square pin power socket	1
	Company Logo	1

FILE PATH - L:\Local Fair Premium Booth 2011\SD-Layouts\13W Lamp\SD-A-Layout-New.dgn

	NOTES UNLESS OTHERWISE SPECIFIED ALL DIMENSIONS ARE IN MM.	REVISION 26-11-08 31-12-2008 15-01-2009 09-02-2009 18-05-2009 15-07-2009 21-01-2010 05-05-2015 08-01-2019	DATE: 08-01-2019	TITLE Premium Booth SD-A-9-R Corner	PROJECT PREMIUM BOOTH 3m x 3m Corner DATE: XXXXXXXX	SHEET SD-A01b
			SCALE: 1 : 50 (A3)			